

**AVAILABLE - 32,960 SF**  
**Hudson Corners Shopping Center - 2131 Old Spartanburg Road**  
**Greer, South Carolina**



**Hughes Commercial  
 Properties, Inc.**

935 South Main St.  
 Suite 202  
 Greenville, SC 29601

864-233-0079 (Phone)

864-233-2093 (Fax)

For more information  
 contact:

**Greg Carter**

**Cortney Carter**



**DEMOGRAPHICS**

	<b>1-Mile</b>	<b>3-Miles</b>	<b>5-Miles</b>
Population 2010 Estimate	9,004	59,515	127,269
Growth 2000 – 2010	21.94%	17.50%	18.90%
2010 Est. Avg. Household Income	\$73,931	\$77,726	\$69,877

No Warranty or representation, expressed or implied is made as to the accuracy of the information contained herein and same is submitted subject to errors, omissions, change of price, rental or other conditions, withdrawal without notice and to any special listing conditions imposed by our principals.

**AVAILABLE - 32,960 SF**  
**Hudson Corners Shopping Center - 2131 Old Spartanburg Road**  
**Greer, South Carolina**



**Hughes Commercial  
Properties, Inc.**

935 South Main St.  
Suite 202  
Greenville, SC 29601

864-233-0079 (Phone)

864-233-2093 (Fax)

For more information  
contact:

**Greg Carter**

**Cortney Carter**

[www.hughescommercial.com](http://www.hughescommercial.com)

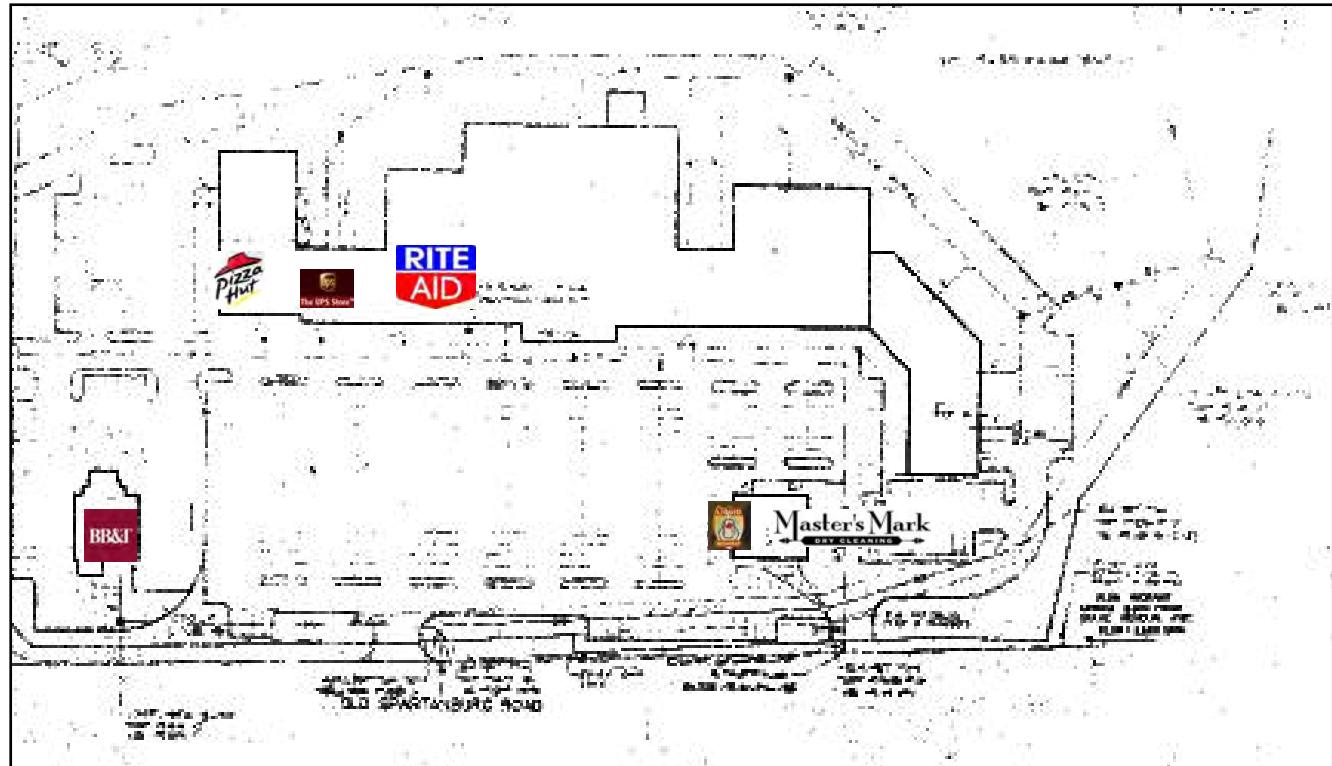

**OFFERING HIGHLIGHTS**

- **Signalized Intersection**
- **Neighborhood Retail Center**
- **309 Shared Parking Spaces**
- **Other Nearby Retailers: BI-LO, Bank of America, Pivotal Fitness, McDonalds, BP**
- **Co-tenants Include: Rite Aid, Golden Tan, UPS Store, It's Yoga, LE Nails, Super Cuts, Pizza Hut/Wing Street, BB&T, Master's Mark, Liquid Highway**